



# WIRESLINE ADAPTER KIT (WLAK)

## FOR DUAL BORE PERMAPAK

### 7" X 5.000" X 4.000"

Manual No:  
**DL-973-7000-1260**

Revision: **B**

Revision Date:  
**08/04/2023**

Authored by: J.Anderson

Approved by: K.Plunkett

#### A) DESCRIPTION

The Wireline Adapter Kit (WLAK) for Permapak Packer is designed to set Permapak Seal Bore Packers with industry standard wireline pressure setting assemblies or comparable equipment.

This setting equipment can also be used with hydraulic setting tools that are configured like the standard setting tool. The setting equipment is designed so the outer sleeve can be adjusted to provide a proper make up to the packer.

**NOTE<sub>1</sub>:** Refer to applicable Permapak Dual Bore Packer technical manuals for tool specific technical information. Packers sold separately.

**NOTE<sub>2</sub>:** This packer requires at least a 30 second burn on the wireline setting tool to ensure a proper set. A burn time less than 30 seconds may shear the setting tool from the packer before fully setting the packer.

#### B) RELATED TOOLS (sold separately)

B-1) 7" & 7-5/8" X 5.000" X 4.000" Dual Bore Permapak Packers (P/N varies depending on customer requirements)—refer to applicable technical manual.

#### C) SPECIFICATION GUIDE

CASING SIZE (INCHES)	TOOL OD (INCHES)	PRESSURE SETTING TOOL	PART NUMBER
7 & 7-5/8	5.81	#20 BAKER E-4	97371X-24
			97371X-72

#### D) PRE-INSTALLATION INSPECTION PROCEDURES

**CAUTION<sub>1</sub>:** Tighten/torque all connections properly before operating tool.

GENERAL THREAD CONNECTION TORQUE RECOMMENDATIONS			
STUB ACME / ACME THREADS	INTERNAL TAPERED TUBING THREADS		PREMIUM THREADS
	UP TO 2-3/8"	GREATER THAN 2-3/8"	
600 – 800 FT-LBS	600 – 800 FT-LBS	800 – 1,200 FT-LBS	Consult thread manufacturer's recommendations.

GENERAL SCREW TORQUE RECOMMENDATIONS									
SCREW SIZE (INCHES)	#6	#8	#10	1/4	5/16	3/8	7/16	1/2	5/8 and larger
TORQUE RANGE (INCH-POUNDS)	5 – 8	10 – 15	18 – 25	25 – 40	50 – 80	90 – 135	160 – 210	250 – 330	450 - 650

Before first use, D&L recommends disassembly and inspection of the tools unless stated otherwise. Ensure parts have not been damaged during shipping. Replace damaged parts with D&L replacement parts. Contact D&L sales for replacement part information.

Before re-using the tool, D&L recommends disassembly and inspection of the tool. Clean parts and ensure parts are in good working condition. Replace worn or damaged parts with D&L replacement parts.

**D & L OIL TOOLS**  
P.O. BOX 52220 TULSA, OK 74152  
PHONE: (800) 441-3504 [www.dloiltools.com](http://www.dloiltools.com)



# WIRELINE ADAPTER KIT (WLAK) FOR DUAL BORE PERMAPAK 7" X 5.000" X 4.000"

Manual No:  
**DL-973-7000-1260**

Revision: **B**

Revision Date:  
**08/04/2023**

Authored by: J.Anderson

Approved by: K.Plunkett

## E) OPERATING PROCEDURES

**CAUTION<sub>2</sub>:** Do not run the tool without properly tightening connections. Running the tool with loose connections may damage the tool and cause malfunction.

Assemble the WLAK to the permapak packer and the pressure setting assembly. Run the assembly to the desired depth. Follow the pressure setting assembly manufacturer's procedures for setting the equipment. After setting, retrieve the setting assembly and disassemble.

## F) STORAGE RECOMMENDATIONS

When preparing the tool for storage, follow the Pre-Installation Inspection Procedures.

Store the tool, if possible, in an enclosed, temperature and humidity controlled environment. Avoid excessively high temperatures over long periods of time. Keep tool dry and protected from condensation. Do not store in contact with or near volatile or corrosive chemicals. Do not store near ozone generating equipment or operations such as welding.

## G) RECOMMENDED HAND TOOLS

- VISE
- GLOVES
- ALLEN WRENCHES
- TAPE MEASURE
- O-RING PICK
- BAR
  - 1/2-INCH
  - 3/4-INCH
- PAINT BRUSH, 2-INCH
- PIPE WRENCH, 3-FT (2 EA)
- "CHEATER" PIPE, 4-FT LONG
- ADJUSTABLE WRENCH, 12-INCH
- CORDLESS DRILL, 18V
- SNAP RING SPREADER PLIERS
- ALIGNING PUNCH
- SCREWDRIVER SET, FLAT-TIPPED
- SOCKET SETS
  - 3/8-INCH DRIVE
  - 1/2-INCH DRIVE
- HAMMERS
  - SLEDGE
  - BALL PEEN
  - DEAD BLOW

## H) ASSEMBLY ONTO PRESSURE SETTING ASSEMBLY AND PERMAPAK DUAL BORE PACKER

**NOTE<sub>3</sub>:** Clean and inspect all parts. Replace all worn and damaged parts. Install parts in proper order, and orientation and tighten/torque all connections properly.

H-1) Install top adapter (4) onto pressure setting assembly. Move upwards and out of way temporarily.

**NOTE<sub>4</sub>:** Pressure setting assembly is not part of WLAK and is not shown.

H-2) Screw outer adapter (2) onto pressure setting assembly.

H-3) Screw set screws (7) into outer adapter (2).

H-4) Temporarily, unscrew and remove set screws from upper bore of packer and unscrew and remove upper bore from packer.

H-5) Install upper bore of packer onto pressure setting assembly. Move upwards and out of way temporarily.

H-6) Install inner adapter (3) into inner mandrel of packer. Align holes in inner adapter (3) with holes in inner mandrel.

H-7) Install driv-lok pins (8) into inner mandrel and inner adapter (3).

H-8) Screw inner adapter (3) into inner adapter mandrel (1).

H-9) Screw set screws (6) into inner adapter (3).

H-10) Screw inner adapter mandrel (1) into pressure setting assembly.

H-11) Screw set screws (5) into inner adapter mandrel (1).

H-12) Move upper bore of packer downwards on pressure setting assembly and screw onto packer. Reinstall set screws into upper bore of packer.

H-13) Move top adapter (4) downwards on pressure setting assembly and screw onto outer adapter (2). Make up parts until packer shoulders up to upper bore of packer.

H-14) Screw set screws (5) into top adapter (4).



# WIRELINE ADAPTER KIT (WLAK) FOR DUAL BORE PERMAPAK 7" X 5.000" X 4.000"

Manual No:  
**DL-973-7000-1260**

Revision: **B**

Revision Date:  
**08/04/2023**

Authored by: J.Anderson

Approved by: K.Plunkett

## I) PARTS LIST

ITEM	QTY	DESCRIPTION	MATERIAL	P/N 97371X-24	P/N 97371X-72
1	1	INNER ADAPTER MANDREL	DLMS110	97371X460-24	97371X460-72
2	1	OUTER ADAPTER	DLMS110	97120102	
3	1	INNER ADAPTER	DLMS110	97371X461	
4	1	TOP ADAPTER	DLMS110	97371X470	
5	3	SOCKET SET SCREW 5/16-18 UNC X 1/2	STEEL	SSS031C050	
6	3	SOCKET SET SCREW 1/4-20 UNC X 3/8	STEEL	SSS025C037	
7	2	SOCKET SET SCREW 1/4-20 UNC X 1/4	STEEL	SSS025C025	
8	10	DRIV-LOK PIN (4800#) 5/16 X 1"	4140	DLP031100	

ASSEMBLED WEIGHT		69 LBS	134 LBS
------------------	--	--------	---------

## J) TECHNICAL ILLUSTRATION

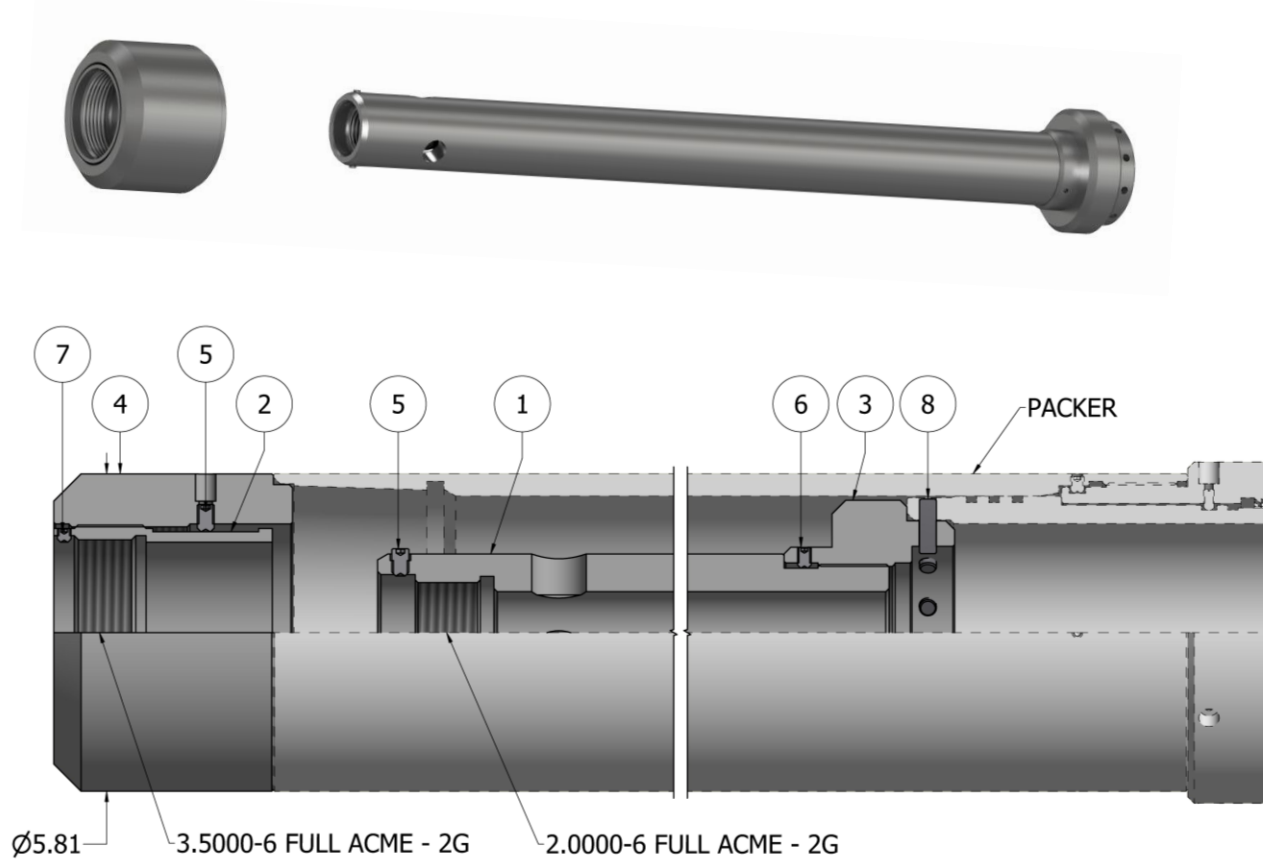



**WIRELINE ADAPTER KIT (WLAK)**  
**FOR DUAL BORE PERMAPAK**  
**7" X 5.000" X 4.000"**

Manual No:  
**DL-973-7000-1260**

Revision: **B**

Revision Date:  
**08/04/2023**

Authored by: *J.Anderson*

Approved by: *K.Plunkett*

**K) REVISION HISTORY**

DATE	REVISION	DESCRIPTION OF CHANGES	REVISED BY	APPROVED BY
08/04/2023	B	Added P/N 97371X-72	J.Anderson	E.Visaez
03/26/2020	A	Created new manual.	-	-