



PRESSURE TEST FIXTURE

F/ 13-3/8" DLH PACKER

Manual No:
DL-937-13375-1308

Revision: **A**

Revision Date:
12/06/2019

Authored by: J.Anderson

Approved by: D.Hushbeck

A) DESCRIPTION

The Pressure Test Fixture for DLH Packers is designed to allow for effective and safe testing of the setting section.

B) RELATED TOOLS (sold separately)

B-1) 13-3/8" DLH Packer (P/N varies)—refer to applicable technical manual.

C) PRE-INSTALLATION INSPECTION PROCEDURES

Before use, D&L recommends disassembly and inspection of the fixture. Ensure parts have not been damaged during shipping. Replace damaged parts with D&L replacement parts. Contact D&L sales for replacement part information.

Re-assemble the fixture after inspection. Install parts in the correct order and orientation.

Inspect packer to be tested before installing test fixture as recommended by D&L in the packer technical manual. Test only if the packer is in good running condition.

D) ASSEMBLY

NOTE₁: Prior to testing, all o-rings and back-up rings (if present) in packer must be properly installed and in good condition—no rips, tears, cuts, etc.

CAUTION₁: Do not test packer in conditions below given temperature range for elastomer. Doing so may prevent o-rings and tighten/torque all connections properly.

D-1) Install top cap (22) onto packer up past lower element.

D-2) Place top half rings (1) onto rubber retainer of packer.

D-3) Install top cap (2) over top half rings (1).

D-4) Install center sleeve (3) onto tool. Screw center sleeve (3) onto top cap (2).

D-5) Back out shear screws in lower slip housing of packer. Move lower slip housing assembly downwards away from lower cone of packer.

D-6) Place bottom half rings (5) below lower cone of packer.

D-7) Install bottom cap (4) over bottom half rings (5). Screw bottom cap (4) into center sleeve (3).

NOTE₂: Bottom half (4) threads will tighten before shouldering up to center sleeve (3).

D-8) Install correct bull plugs in both end of packer.

NOTE₃: Bull plugs not included in pressure test fixture. Sold separately

D-9) Proceed with pressure test.

E) TESTING PROCEDURES

E-1) Fill test of port of bull plug with hydraulic oil or inhibited water.

E-2) Apply pressure to test port. Pressure up to 2,500 psi may be applied.

WARNING: Do NOT exceed 2,500 PSI. If testing over 2,500 PSI, contact D&L sales.

E-3) Hold and observe for leaks.

E-4) Release pressure.

NOTE₂: The test program above is only a suggestion from D&L. It is not the only possible way to test the packer.

D & L OIL TOOLS
P.O. BOX 52220 TULSA, OK 74152
PHONE: (800) 441-3504 www.dloiltools.com

This document is uncontrolled when printed. For the current revision, refer to the electronic copy in the Vault database.



PRESSURE TEST FIXTURE

F/ 13-3/8" DLH PACKER

Manual No:
DL-937-13375-1308

Revision: **A**

Revision Date:
12/06/2019

Authored by: J.Anderson

Approved by: D.Hushbeck

F) DISASSEMBLY

F-1) Clamp packer in vise.

F-1.1) Remove bull plugs from both ends of packer.

F-1.2) Unscrew and remove bottom cap (4) from connecting sleeve (3).

F-1.3) Remove bottom half rings (5) from packer.

F-1.4) Unscrew and remove connecting sleeve (3) from top cap (2).

F-1.5) Move top cap (2) to access top half rings (1).

F-1.6) Remove top half rings (1) from packer.

F-1.7) Remove top cap (2) from packer.

F-1.8) Move lower slip housing assembly of packer into running position. Align threaded holes in lower slip housing with counterbored holes in packer mandrel.

F-1.9) Screw shear screws into lower slip housing. Tighten shear screws until they contact packer mandrel. Back out 1/4 turn.

F-2) Unclamp and remove packer from vise.

G) PARTS LIST

ITEM	QTY	DESCRIPTION	MATERIAL	P/N 93713
1	2	TOP HALF	DLMS110	93713610
2	1	TOP CAP	DLMS110	93713620
3	1	CENTER SLEEVE	DLMS110	93713210
4	1	BOTTOM CAP	DLMS110	93713630
5	2	BOTTOM HALF	DLMS110	93713640

ASSEMBLED WEIGHT		419 LBS
------------------	--	---------



PRESSURE TEST FIXTURE

F/ 13-3/8" DLH PACKER

Manual No:
DL-937-13375-1308

Revision: **A**

Revision Date:
12/06/2019

Authored by: *J.Anderson*

Approved by: *D.Hushbeck*

H) TECHNICAL ILLUSTRATION

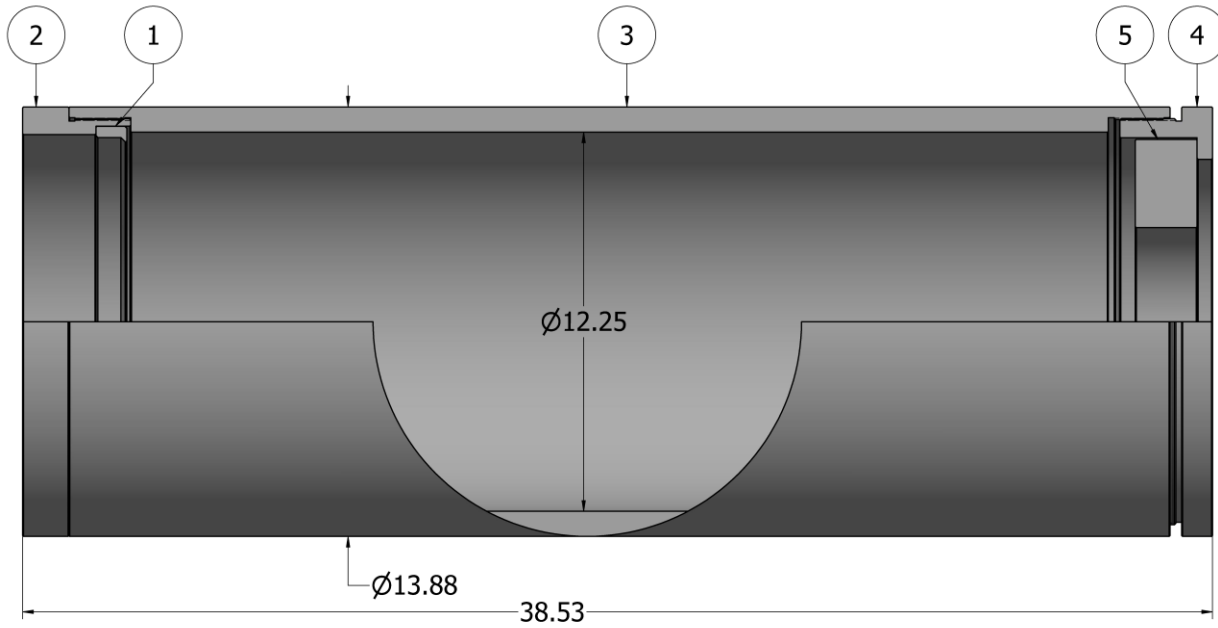

I) REVISION HISTORY

DATE	REVISION	DESCRIPTION OF CHANGES	REVISED BY	APPROVED BY
12/06/2019	A	Created new manual	-	-